

EAST AFR PROJ

C O
23125

NO
19 MAR 20

601

LAND FOR CABLE ONLY AT KOMBASA

1920

Reports 3 or 4 acres should be sufficient. In the event of an extension of lease being granted the area at present allotted should be curtailed. Is not in favour of a freehold grant.

to Botswana Govt

- (1) The previous 10 1/2 acre lease expires in 1929.
- (2) It is clear from this report that the Govt's application for freehold should not be entertained.
- (3) It is equally clear that the present area is too large for the Govt's present requirements.
- (4) Report from the Govt dated 25/11/19 which is not taking (see 5/12/19) which probably need not be formally considered. It would be desirable that we may get a reply to the

*Dist Conf 25 May 20 1920
Copy comes off or by 10/11*

next subsequent Paper

W 8/23873

CONFIDENTIAL

23125

603

March, 1920.

RE 10-11-20

My Lord,

Govt/52926/19

Map

Govt/6287/19

I have the honour to acknowledge the receipt of Your Lordship's Confidential despatch of 22nd September referring to paragraphs 4 and 5 of Your Lordship's Confidential despatch of 2nd April 1919 regarding the East and South African Telegraph Company's application for a grant of freehold land atombasa.

2. I have caused the Postmaster General to report on the requirements of this Company, and he is of the opinion that they will be met, both for the present and the future, by a holding of 3 to 4 acres. This area is shown on the enclosed Map and secures to the Company the sandy bay in which their cable lands. This area is exclusive of the land on which the cable tanks are built and which was acquired by the Company by private purchase.

3. In the balance of the land at present leased to the Company and consisting of some six acres, is included some very valuable foreshore,

THE RIGHT HONOURABLE

VISCOUNT MILNER, P.C., F.R.S., G.C.M.G., &c. &c.,

SECRETARY OF STATE FOR THE COLONIES,

DOWNING STREET,

LONDON, S.W.

an interior section of which is required to compensate adjoining owners through whose property it is desirable to obtain rights of way.

4. The possibility of re-claiming low-lying land and of areas covered by shallow water
604
be borne in mind, and I am of the opinion that Government should take advantage of any opportunity of re-acquiring land fronting on Kilindini Harbour.

5. I concur in the opinion expressed by the Postmaster General and, in view of the uses to which a part of this land could be put, I recommend that, in the event of an extension of lease being granted to the Company, the area at present held by them should be curtailed and that a proviso be inserted as recommended in General Post Office letter No. 57520/19 of September 25th enclosed in Your Lordship's Despatch Confidential of October 7th. I am not in favour of a freehold grant.

I have the honour to be,

Your Lordship's
humble obedient servant



ACTING GOVERNOR.

120/55/24

For 23125/2000

DRAFT.

To See
for

MINUTE.

- Mr. Gracie
- Mr. Parson
- Mr.
- Mr. White
- Mr. H. Lambert
- Mr. H. [unclear]
- Mr. [unclear]
- Mr. Amery
- Mr. [unclear]

list ref to Paul the
 N. 67520 of the 25th Sept.
 (55. 14) last, I am a letter to you
 for the rate of the Phil.
 the an... corres.

31/10/1900

20 (see 1st)

with the... of the...
 regarding the application
 by the Eastern S. Asian
 Tel Co. for the Grant of the
 License of the...
 which they...
 held the...
 and... there

by W. A. [unclear]
 11/11/00

Enclosures of



Source of Bearings & Distances

Line	Bearing	Distance
177	180	101.70
178	200	101.33
179	210	101.33
180	225	101.33
181	240	101.33
182	255	101.33
183	270	101.33
184	285	101.33
185	300	101.33
186	315	101.33
187	330	101.33
188	345	101.33
189	360	101.33
190	375	101.33
191	390	101.33
192	405	101.33
193	420	101.33
194	435	101.33
195	450	101.33
196	465	101.33
197	480	101.33
198	495	101.33
199	510	101.33
200	525	101.33
201	540	101.33
202	555	101.33
203	570	101.33
204	585	101.33
205	600	101.33
206	615	101.33
207	630	101.33
208	645	101.33
209	660	101.33
210	675	101.33
211	690	101.33
212	705	101.33
213	720	101.33
214	735	101.33
215	750	101.33
216	765	101.33
217	780	101.33
218	795	101.33
219	810	101.33
220	825	101.33
221	840	101.33
222	855	101.33
223	870	101.33
224	885	101.33
225	900	101.33
226	915	101.33
227	930	101.33
228	945	101.33
229	960	101.33
230	975	101.33
231	990	101.33
232	1005	101.33
233	1020	101.33
234	1035	101.33
235	1050	101.33
236	1065	101.33
237	1080	101.33
238	1095	101.33
239	1110	101.33
240	1125	101.33
241	1140	101.33
242	1155	101.33
243	1170	101.33
244	1185	101.33
245	1200	101.33
246	1215	101.33
247	1230	101.33
248	1245	101.33
249	1260	101.33
250	1275	101.33
251	1290	101.33
252	1305	101.33
253	1320	101.33
254	1335	101.33
255	1350	101.33
256	1365	101.33
257	1380	101.33
258	1395	101.33
259	1410	101.33
260	1425	101.33
261	1440	101.33
262	1455	101.33
263	1470	101.33
264	1485	101.33
265	1500	101.33
266	1515	101.33
267	1530	101.33
268	1545	101.33
269	1560	101.33
270	1575	101.33
271	1590	101.33
272	1605	101.33
273	1620	101.33
274	1635	101.33
275	1650	101.33
276	1665	101.33
277	1680	101.33
278	1695	101.33
279	1710	101.33
280	1725	101.33
281	1740	101.33
282	1755	101.33
283	1770	101.33
284	1785	101.33
285	1800	101.33
286	1815	101.33
287	1830	101.33
288	1845	101.33
289	1860	101.33
290	1875	101.33
291	1890	101.33
292	1905	101.33
293	1920	101.33
294	1935	101.33
295	1950	101.33
296	1965	101.33
297	1980	101.33
298	1995	101.33
299	2010	101.33
300	2025	101.33

Co-ordinates

Station	Latitude	Longitude
1	0° 00' 00"	33° 00' 00"
2	0° 00' 00"	33° 00' 00"
3	0° 00' 00"	33° 00' 00"
4	0° 00' 00"	33° 00' 00"
5	0° 00' 00"	33° 00' 00"
6	0° 00' 00"	33° 00' 00"
7	0° 00' 00"	33° 00' 00"
8	0° 00' 00"	33° 00' 00"
9	0° 00' 00"	33° 00' 00"
10	0° 00' 00"	33° 00' 00"
11	0° 00' 00"	33° 00' 00"
12	0° 00' 00"	33° 00' 00"
13	0° 00' 00"	33° 00' 00"
14	0° 00' 00"	33° 00' 00"
15	0° 00' 00"	33° 00' 00"
16	0° 00' 00"	33° 00' 00"
17	0° 00' 00"	33° 00' 00"
18	0° 00' 00"	33° 00' 00"
19	0° 00' 00"	33° 00' 00"
20	0° 00' 00"	33° 00' 00"
21	0° 00' 00"	33° 00' 00"
22	0° 00' 00"	33° 00' 00"
23	0° 00' 00"	33° 00' 00"
24	0° 00' 00"	33° 00' 00"
25	0° 00' 00"	33° 00' 00"
26	0° 00' 00"	33° 00' 00"
27	0° 00' 00"	33° 00' 00"
28	0° 00' 00"	33° 00' 00"
29	0° 00' 00"	33° 00' 00"
30	0° 00' 00"	33° 00' 00"

Line	Bearing	Distance
1	180	101.33
2	200	101.33
3	210	101.33
4	225	101.33
5	240	101.33
6	255	101.33
7	270	101.33
8	285	101.33
9	300	101.33
10	315	101.33
11	330	101.33
12	345	101.33
13	360	101.33
14	375	101.33
15	390	101.33
16	405	101.33
17	420	101.33
18	435	101.33
19	450	101.33
20	465	101.33
21	480	101.33
22	495	101.33
23	510	101.33
24	525	101.33
25	540	101.33
26	555	101.33
27	570	101.33
28	585	101.33
29	600	101.33
30	615	101.33
31	630	101.33
32	645	101.33
33	660	101.33
34	675	101.33
35	690	101.33
36	705	101.33
37	720	101.33
38	735	101.33
39	750	101.33
40	765	101.33
41	780	101.33
42	795	101.33
43	810	101.33
44	825	101.33
45	840	101.33
46	855	101.33
47	870	101.33
48	885	101.33
49	900	101.33
50	915	101.33
51	930	101.33
52	945	101.33
53	960	101.33
54	975	101.33
55	990	101.33
56	1005	101.33
57	1020	101.33
58	1035	101.33
59	1050	101.33
60	1065	101.33
61	1080	101.33
62	1095	101.33
63	1110	101.33
64	1125	101.33
65	1140	101.33
66	1155	101.33
67	1170	101.33
68	1185	101.33
69	1200	101.33
70	1215	101.33
71	1230	101.33
72	1245	101.33
73	1260	101.33
74	1275	101.33
75	1290	101.33
76	1305	101.33
77	1320	101.33
78	1335	101.33
79	1350	101.33
80	1365	101.33
81	1380	101.33
82	1395	101.33
83	1410	101.33
84	1425	101.33
85	1440	101.33
86	1455	101.33
87	1470	101.33
88	1485	101.33
89	1500	101.33
90	1515	101.33
91	1530	101.33
92	1545	101.33
93	1560	101.33
94	1575	101.33
95	1590	101.33
96	1605	101.33
97	1620	101.33
98	1635	101.33
99	1650	101.33
100	1665	101.33
101	1680	101.33
102	1695	101.33
103	1710	101.33
104	1725	101.33
105	1740	101.33
106	1755	101.33
107	1770	101.33
108	1785	101.33
109	1800	101.33
110	1815	101.33
111	1830	101.33
112	1845	101.33
113	1860	101.33
114	1875	101.33
115	1890	101.33
116	1905	101.33
117	1920	101.33
118	1935	101.33
119	1950	101.33
120	1965	101.33
121	1980	101.33
122	1995	101.33
123	2010	101.33
124	2025	101.33

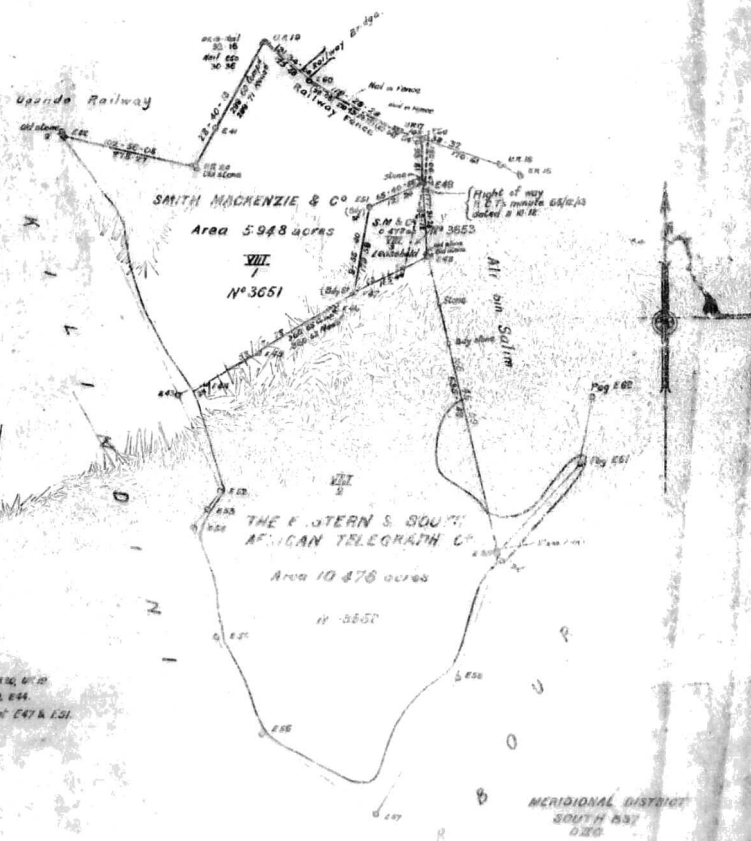

Scale of 1 inch = 100 feet
 100 = 1000, 200 = 2000, 300 = 3000, 400 = 4000, 500 = 5000, 600 = 6000, 700 = 7000, 800 = 8000, 900 = 9000, 1000 = 10000

PLAN OF
 PORTION OF
 DISTRICT OF KINSHASA
 PROVINCE OF SEYDLIE
 OFFICE COPY N° 3651/3

Continuing
Refered 2 Squares

Line	Station	Area
101	101	2 48
102	102	24 10
103	103	24 10
104	104	24 10
105	105	24 10
106	106	24 10
107	107	24 10
108	108	24 10
109	109	24 10
110	110	24 10
111	111	24 10
112	112	24 10
113	113	24 10
114	114	24 10
115	115	24 10
116	116	24 10
117	117	24 10
118	118	24 10
119	119	24 10
120	120	24 10

Line	Station	Area
121	121	24 10
122	122	24 10
123	123	24 10
124	124	24 10
125	125	24 10
126	126	24 10
127	127	24 10
128	128	24 10
129	129	24 10
130	130	24 10
131	131	24 10
132	132	24 10
133	133	24 10
134	134	24 10
135	135	24 10
136	136	24 10
137	137	24 10
138	138	24 10
139	139	24 10
140	140	24 10

Line	Station	Area
141	141	24 10
142	142	24 10
143	143	24 10
144	144	24 10
145	145	24 10
146	146	24 10
147	147	24 10
148	148	24 10
149	149	24 10
150	150	24 10

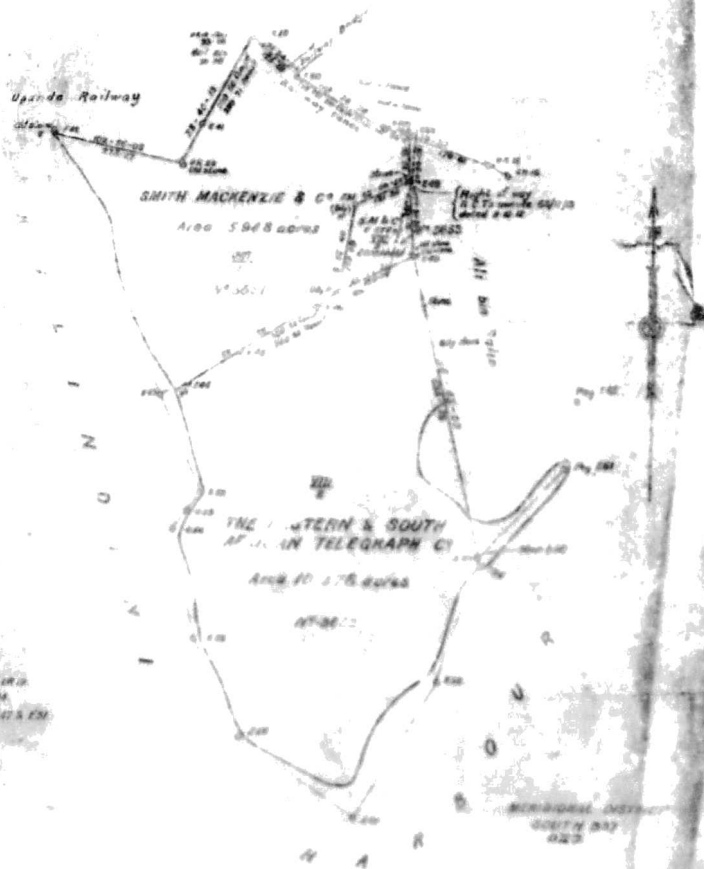

Plotted in accordance with the instructions of the Surveyor-General, Natal, dated 11/1/12.

Surveyed by J. H. G. ...

PLAN OF
Portion of
District of NORTHERN
PROVINCE of NATAL
OFFICE COPY 36

PUBLIC RECORD OFFICE

C0553/231

END

TOTAL EXPOSURES → 751

PUBLIC RECORD OFFICE

CO 533/232

ORDER NO. ⇒639
CAMERA NO. ⇒22
OPERATOR. ⇒JMK
REDUCTION. ⇒12
EMULSION NO. ⇒292062
DATE. ⇒15/2/71

CROWN COPYRIGHT

THESE COPIES ARE SUPPLIED FOR INFORMATION
AND RESEARCH ONLY-NO REPRODUCTION MAY BE
MADE FOR PUBLICATION WITHOUT THE ASSENT OF
THE PUBLIC RECORD OFFICE

PUBLIC RECORD OFFICE

THE PAGES IN THIS VOLUME ARE TOO
TIGHTLY BOUND FOR ALL WORDS TO BE
REPRODUCED IN ENTIRETY

VOL

DATE

SUBJECT

- 346 1 1 1920 21 - Taxation
- 347 1 1 1920 21 - Taxation
- 348 1 1 1920 21 - Taxation
- 349 1 1 1920 21 - Taxation
- 350 1 1 1920 21 - Taxation
- 351 1 1 1920 21 - Taxation
- 352 1 1 1920 21 - Taxation
- 353 1 1 1920 21 - Taxation
- 354 1 1 1920 21 - Taxation
- 355 1 1 1920 21 - Taxation
- 356 1 1 1920 21 - Taxation
- 357 1 1 1920 21 - Taxation
- 358 1 1 1920 21 - Taxation
- 359 1 1 1920 21 - Taxation
- 360 1 1 1920 21 - Taxation
- 361 1 1 1920 21 - Taxation
- 362 1 1 1920 21 - Taxation
- 363 1 1 1920 21 - Taxation
- 364 1 1 1920 21 - Taxation
- 365 1 1 1920 21 - Taxation
- 366 1 1 1920 21 - Taxation
- 367 1 1 1920 21 - Taxation
- 368 1 1 1920 21 - Taxation
- 369 1 1 1920 21 - Taxation
- 370 1 1 1920 21 - Taxation
- 371 1 1 1920 21 - Taxation
- 372 1 1 1920 21 - Taxation
- 373 1 1 1920 21 - Taxation
- 374 1 1 1920 21 - Taxation
- 375 1 1 1920 21 - Taxation
- 376 1 1 1920 21 - Taxation
- 377 1 1 1920 21 - Taxation
- 378 1 1 1920 21 - Taxation
- 379 1 1 1920 21 - Taxation
- 380 1 1 1920 21 - Taxation

17304-

Message from the Officer Administering the Government
of the East Africa Protectorate to the
State for the Colonies.

Tele. 2 April, 1920.

(Received Colonial Office C.45 12th April, 1920)

39528
19

9/12

18d 1st April Your telegram 9th July 1919 re offenders
German East Africa surrender Ordinance 1920 which
follows by post is now inoperative since to date
of British military occupation in German East Africa
I would be grateful for telegraphic approval to extend
period as long as necessary by sending ordinance

FORGING

TELEGRAM

RECEIVED FROM CHIEF CABLE STATION, ELECTRA HOUSE, CHURCH LANE, LONDON, W.C.2.
REPLIES SHOULD BE ORDERED

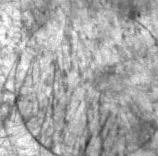

Adopted words are in full in the margin. See also the margin for the meaning of the words. The words in the margin are in full in the margin. The words in the margin are in full in the margin.

WKT
BVJ 4 APR

hgp
WKT



LA 57 B NAIROBI 36/35 1 QS

86 CHAPELRIES LN

168 AND BEAR UNWANTED FUGITIVE OFFENDERS

GENNAVERO SURRENDER OVERBROWED TUNDROL AS WHICH

FIGURE IS NOW IN OPERATIVE OXIDENLO

CESSATION OR BRITISH MILITARY

OCCUPATION IN GENNAVERO SILVERROD

Printed in Great Britain by the British Post Office

771
1953
LONDON

CHAPTER 1

^{to be granted for}
RELATIONS

TELEGRAPHIC

APPROVAL

^{to extend}
EXPRESSURE

PERIOD

^{to be necessary}
LISHEROUS

BY

AMENDING

^{to be necessary}
OVERCROWD

HOWING

12/4/20

DRAFT

Chel. (Code)

Sent 1³⁰
12/4/20

MINUTE.

- Mr. Bramley, 9 April
- Mr. Battonley, 10/4/20
- Mr. Risley, 10/4/20
- Mr. Grindle
- Mr. H. Lamb
- Mr. H. Hunt
- Mr. G. Fiddes
- Mr. Amory
- Lord Milner

1. Form tel. 1 April No 168
advises
 'I am advised that'
 pending 'establishment'
 of 'administration'
 under 'Order in Council'
 British 'military'
 occupation, must be
 left 'to continue'

420
Concerning ordnance work

There

THE FUGITIVE OFFENDERS (GERMAN EAST AFRICA)
ORDINANCE NO. 10, 1920.

STATEMENT OF OBJECTS AND REASONS.

7

The object of the Ordinance is to enable this Government to effect the return to the territory lately known as German East Africa then in British Military occupation of any person accused of an offence punishable by law in that territory.

The effect of the war was to abrogate any Treaty made between Great Britain and Germany with the result that all extradition agreements made with Germany and the fugitive provisions of the latter Ordinance, 1918, became inoperative. This position was represented by the local Government to the Secretary of State, and it was suggested that the best means to supply the power of arrest and return of fugitive offenders would be by Ordinance on the understanding that the Government of the occupied territory reciprocated.

This course was agreed to by the Secretary of State subject to the proviso that such legislation should be limited to the period of British Military occupation.

The Acting Administrator of the occupied territory was by Royal Commission under His Majesty's High Honorary Letters Patent with the necessary power to surrender fugitives from His Protectorate.

The Ordinance is designed to give effect to the Secretary of State's instructions.

Nairobi,

SEYMOUR G. GOWER

10th day of April, 1920.

ADMINISTRATOR