

was scarcely a sufficient  
 penalty in a case of vessel  
 service misconduct, and  
 should have been accompanied  
 by a reduction in seniority.  
 In view, however, of the fact  
 that his conduct will,  
 in the course, be taken into  
 consideration when his  
 claims to promotion ~~are~~  
 are discussed, I do not  
 wish to reopen the matter  
 by discussing that point.  
 The amount should have  
 been ~~paid~~ now.

I am

EAST AFR. PROT.

C. O.

2064

REC'D  
 18 JAN 13

998  
 2064 12/13

Senior  
 Conf  
 Field 140

Date  
 1912

December

Previous Paper

2

204/13

MILINDINI DE P WATER PIER

This copy of letter from the General Manager from which it would appear that from the information now available the scheme propounded by the Consulting Engineers is impracticable. Investigations will proceed pending the arrival of the expert.

Dr J. Johnson

Dr Johnson's letter to the  
 the 29<sup>th</sup>

Sent copy of the report to the  
 C.A. calling attention to what Mr. Taylor  
 says in the 3<sup>rd</sup> para of the letter &  
 asking that the paper may be passed  
 on to the C.A. so as to read Mr. Johnson  
 before he sails - a more or less  
 & reply

A. J. R.  
 20/11  
 Donee  
 20.1.13

Subsequent Paper

204/13

2064

C.O.  
2064 684  
REC'D  
18 JAN 13

GOVERNMENT HOUSE  
NAIROBI,  
BRITISH EAST AFRICA.

EAST AFRICA PROTECTORATE

CONFIDENTIAL No. 140

23rd December 1912.

998  
OFFICE

Sir,

4  
22951  
12

With reference to my telegram No. 179 of the 17th of October,\* and my Confidential despatch No. 116 of the 21st idem on the subject of the Deep Water Pier at Kilindini, I have the honour to transmit herewith a copy of a letter from the General Manager, from which it would appear that, in view of the information now obtained, the scheme propounded by Messrs Rendel [and] Robertson is impracticable.

Gen. Manager,  
R., 14/16.12.12.

2. Further examination, however, will be made pending the arrival of the expert referred to in your despatch No. 751 of November 9th in order that the fullest particulars may be available for him on arrival.

4  
22951  
12

I have the honour to be,

Sir,

Your humble, obedient servant,

*A. Longway Beyield.*

GOVERNOR.

THE RIGHT HONOURABLE

LEWIS HARCOURT, F.C., M.P.,

SECRETARY OF STATE FOR THE COLONIES,

DOWNING STREET, LONDON, S.W.

\* No 32951  
+ N2 32951

Concessions - 14737 - 20

Enclosure  
in Dispatch No. 23/12-1912

685

Encl in No.

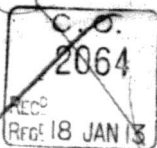

NO. 452  
24a

14th December /12

KILINDINI HARBOUR.

SIR,

I have the honour to forward a report by Mr. Galley as to the results so far arrived at through the borings done at Kilindini.

2. The results show that the proposal of Messrs. Rendal & Robertson to excavate a harbour by cutting away the rock is impracticable. I saw that myself on my visit to Kilindini - the day of my arrival at the Port; but as to what system of construction it will be best to adopt must remain for decision until the results by further borings and investigations be known.

3. I saw Sir William Mathews and his partners the new Consulting Engineers for the Harbour Construction before leaving England, and I was promised a letter detailing the particulars required to be obtained by us prior to the arrival of one of the partners, who is coming

TO THE HON'BLE

THE CHIEF SECRETARY

TO THE GOVERNMENT

NAIROBI.

out

-2-

(out) to advise us: but this letter is not yet to hand.

4. Meanwhile Mr. Gailey is collecting all necessary information which we consider the Consulting Engineers will call for and no time is being wasted.

~~ENCLOSURE~~  
~~P. 277.~~

~~letter from the Engineer  
in charge - Kilindini  
Deep Water Pier and  
Plan No. 303 - 1912.~~

*etc*  
I have the honor to be,

Sir,

Your obedient servant,

S. H. E. Taylor.

General Manager,  
UGANDA RAILWAY.

3

Engineer in Charge  
Kilindini Deep Water Pier.

The Supdt. Way & Works,  
Uganda Railway.  
N a i r o b i .

Sir,

Confirming my wire of November 30th giving result of first borings with the diamond drill I have to report as follows:-

The first bore taken about high water mark on cross section No.4 gave 6'. 6" of sand and 3'. 6" of very hard sand stone of which I sent you a specimen core, On getting through the rock the drill stopped on some iron substance as the pump brought up nothing but flakes of rust. I put down the steel cutters but failed to get through it so moved the plant some 50 feet North. This bore gave 5 feet sand, 4'. 6" hard sand stone similar to the first, and 15 feet of clean coarse sand without again reaching any rock. This confirms the formation as seen in the exposed face of the cliff of which the site of the bore was a continuation, and in fact, indicates that the rock formation is becoming less as it goes further out, as the cliff shows alternate seams of rock and sand from 2 to 4 feet in thickness, I am now endeavouring to trace the rock by boring on the low water line on cross section No.15 after which I shall move the plant out to the 5 fathom line.

So far everything points to prove that the suggested scheme of cutting away the rock, and building the wall on the low water line, is quite impracticable and I am of opinion that this will be further confirmed by the later borings,

4

borings, and that the idea may be abandoned.

Surface borings by driving rails through the sand until rock is reached show almost everywhere a sufficient depth of clean sand on which to found a concrete wall and these borings I propose to confirm by a water jet.

Extended survey and soundings are being carried out and result will be sent you in due course.

*etc*  
I have the honour to be,

Sir,

Your obedient servant,

*J. H. Bailey*

Engineer in Charge  
Kilindini Deep Water Pier.

5

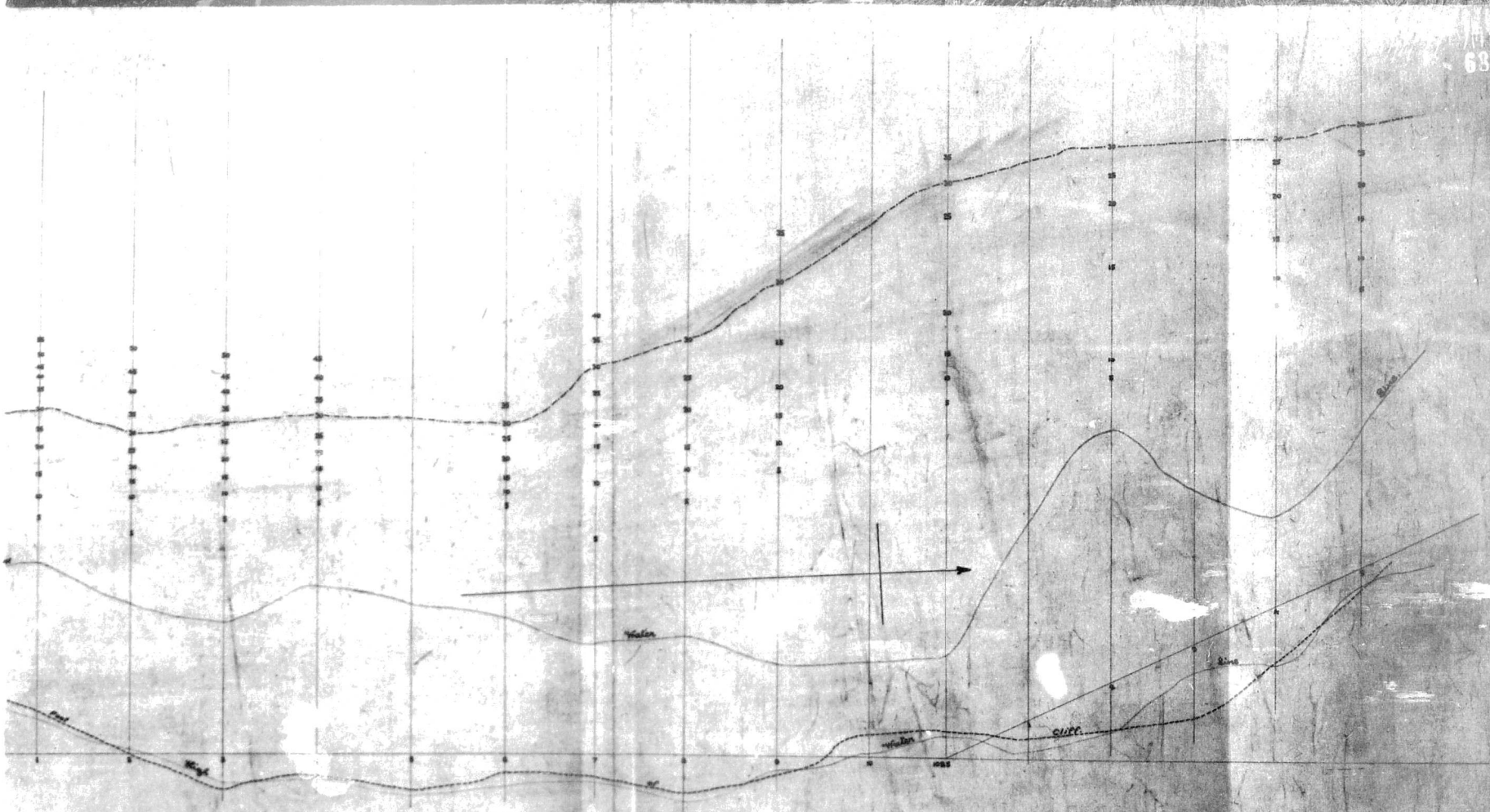

**UCANDA RAILWAY.**

**PLAN OF KILINDINI HARBOUR SHOWING**

**SITE OF DEEP WATER PIER.**

**1912.**

**SCALE 100 FEET = 1 INCH.**

**PLAN N<sup>o</sup> 536**

*Richard  
360 23/9/12*







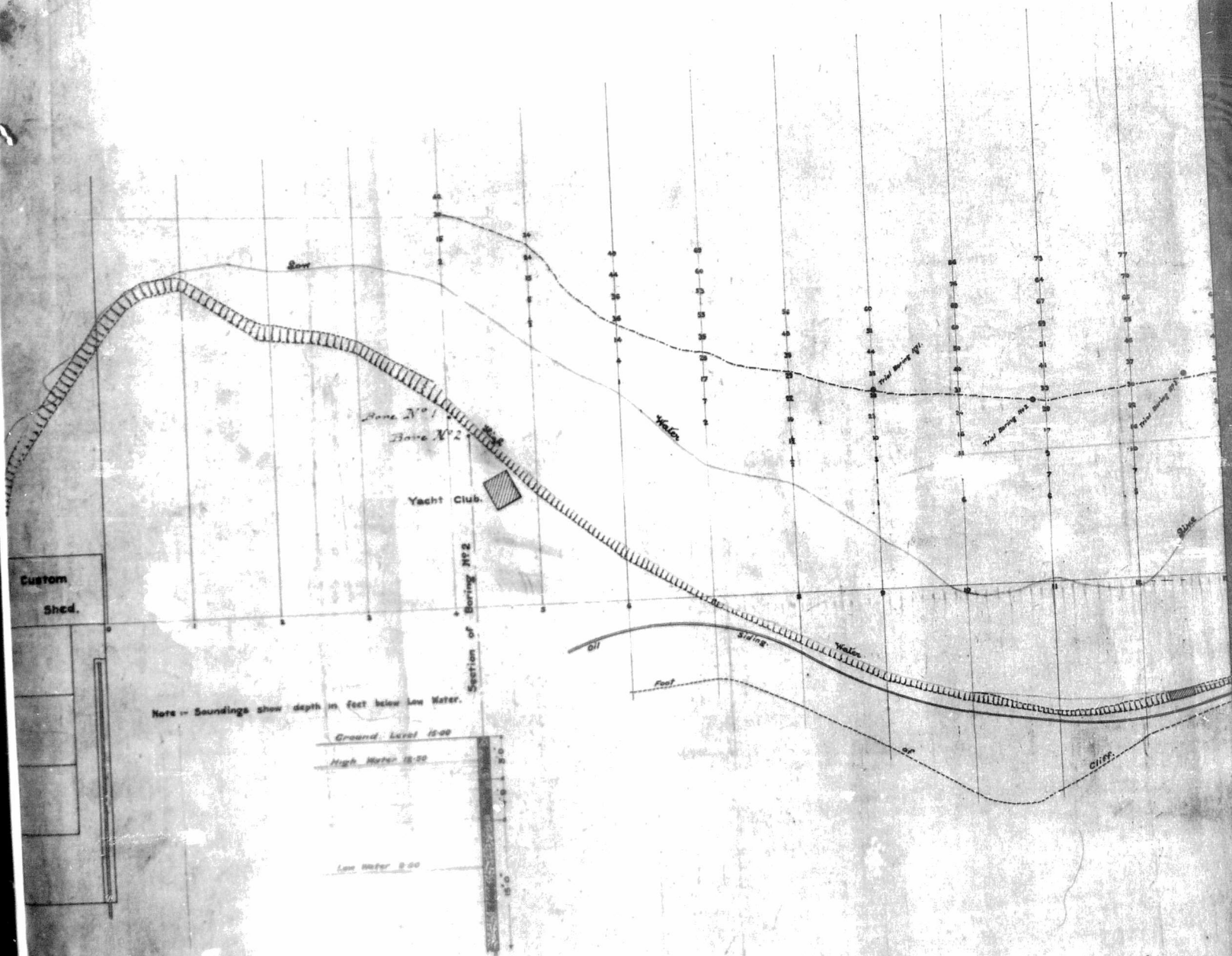

Note - Soundings show depth in feet below Low Water.

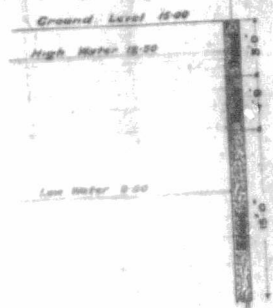

Custom  
Shed.

Yacht Club.

Pier  
Pier No. 1  
Pier No. 2

Section of Boring No. 2

Oil

Sling

Yalco

Cliff

Bluff

or

Yalco

True Bearing 91°

True Bearing 101°

True Bearing 91°

Sewer

C. D.  
R. 21 JAN  
D. 11

*22*  
*E.A.P*  
2064/13.

Pressing

*Ans d 29/2/13*

DRAFT.

*Ann Agent.*

21 January 1913.

MINUTE.

Mr. *W. H. ...* 21. 1. 13.

Mr. *B. ...* 21 *to*

Sir G. Fiddes.

Sir H. Just.

Sir J. Anderson.

Lord Em...

Mr. Harcourt.

Gentlemen,

*London, 21st*  
*W. ... to the letter*  
*from this department dated*  
*January 21st 1913* I am  
dis. of Mr. Secretary Harcourt

*note on 20th 11*  
*British ...*  
*last letter acc. to*  
*S.R.*

to forward the accompanying  
with enclosures,  
copy 2 a dispatch, issued  
from the Governor's *East Office*

*For Governor (Conf) only date 23/1/13*  
*all at 11/13*  
*20/1/13*  
*There is a dup plan*  
*J.H.*

Residents in the vicinity of  
the Kibindini Dispensary  
K. plan which accompanied  
together with copies of  
the dup. is forwarded in  
its enclosures and the original  
plans enclosed to them.